

Independent Living. Garden Floor Plans.



**MOUNT
ANGEL
TOWERS**

Our apartments have a wide variety of floorplans to choose from. Each Garden apartment has its own patio with direct access to our landscaped grounds.

Garden 1 Bedroom 550 sf

PRICE RANGE:

\$3,025 - \$3,275 per month

Price ranges quoted are as of the date the user visited the website and are subject to change at any time.

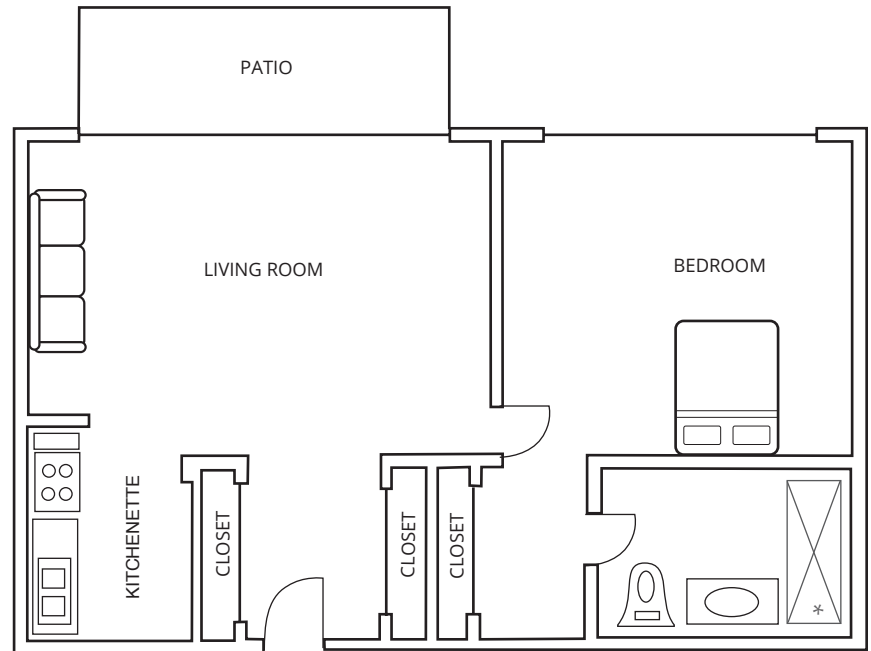

GARDEN APARTMENTS INCLUDE:

- Spacious closets
 - Abundant windows
 - Heat & air conditioning controlled within each unit
 - Bathrooms equipped for accessibility and safety
 - Fully-equipped kitchens
 - Pets welcome
 - Emergency call system
 - All utilities & cable tv (not phone or internet)
 - Patios that lead directly to landscaped gardens
 - Two meals per day
-

CALL TO BOOK A TOUR:

503-845-7211

www.MountAngelTowers.com